

DESIGN FILTRATION MICROZONE CUSTOM CLEANROOM SOLUTIONS

With over 50 years of expertise in particulate and contamination control, Design Filtration Microzone (DFMZ) is your trusted partner for tailored cleanroom solutions. Our commitment to excellence is reflected in our high-quality products, efficient designs, and superior customer service. Our innovative solutions are designed to help you achieve your cleanroom goals, whether you're focused on precision, compliance, or operational growth. We understand the critical importance of safeguarding your people, your products, and the environment.



Cleanroom Specifications and Options:

- Wall Systems
- Swing Doors
- Ceiling System
- Windows
- Fan Filter Modules
- LED Flat Panel Lights
- Pass-through Options



Contact Us:

www.dfmzgroup.com

sales@dfmzgroup.com

888-636-8609



DFMZ 1.5 CLEANROOM WALL SYSTEM

The DFMZ 1.5 Cleanroom Wall System is our most popular wall system. It's key to a rigid and strong enclosure at a very attractive price. Wall modules are constructed with a heavy-duty, anodized, extruded aluminum frame containing a choice of insert panels. The DFMZ 1.5 System is used in a wide variety of applications. Originally developed for Pharmacy Compounding, it is also used for pharmaceutical manufacturing, electronic production and university research labs.



Key Features:

- Heavy-duty, anodized, extruded aluminum frame (1-5/8" or 2" thick)
- Solid white aluminum composite and clear acrylic inserts
- Ceiling height of 8'; however, virtually any height up to 12' can be provided
- Sliding or swing doors constructed with extruded aluminum frames and clear acrylic inserts
- Anodized, aluminum service chases with snap covers allow for easy installation and future modification of services
- Typically installed along with DFMZ Ceiling Grid
- DFMZ - Double Track - Flush face on both sides for all interior walls

DFMZ ACM WALL CLADDING

The DFMZ Honeycomb wall cladding is composed of a 1/4" thick aluminum honeycomb wall with white painted facing material that is non-particle shedding.

Key Features:

- Excellent for transforming an existing room into a cleanroom
- **Easy Installation:**
 - Cladding is installed on existing wall surface, making for easy installation without too much modification to existing structures and environment.
- **Wall Modules:**
 - Wall module heights: 10' (3,048 mm)
 - Wall modules are firmly fastened together by battens between each sheet of cladding



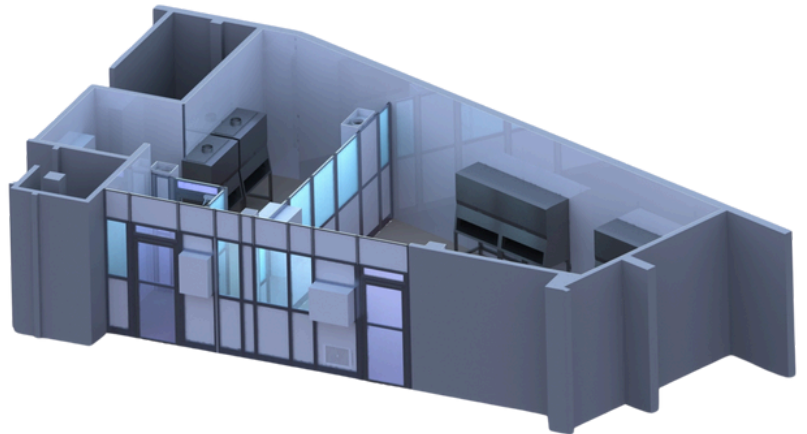
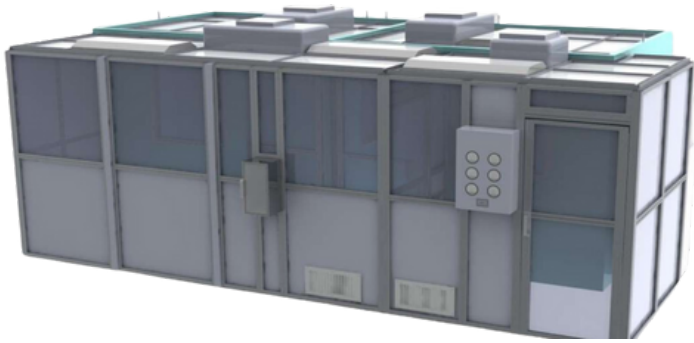

Contact Us:

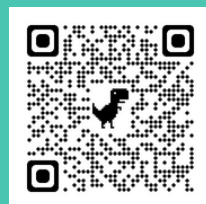

www.dfmzgroup.com

sales@dfmzgroup.com

888-636-8609