

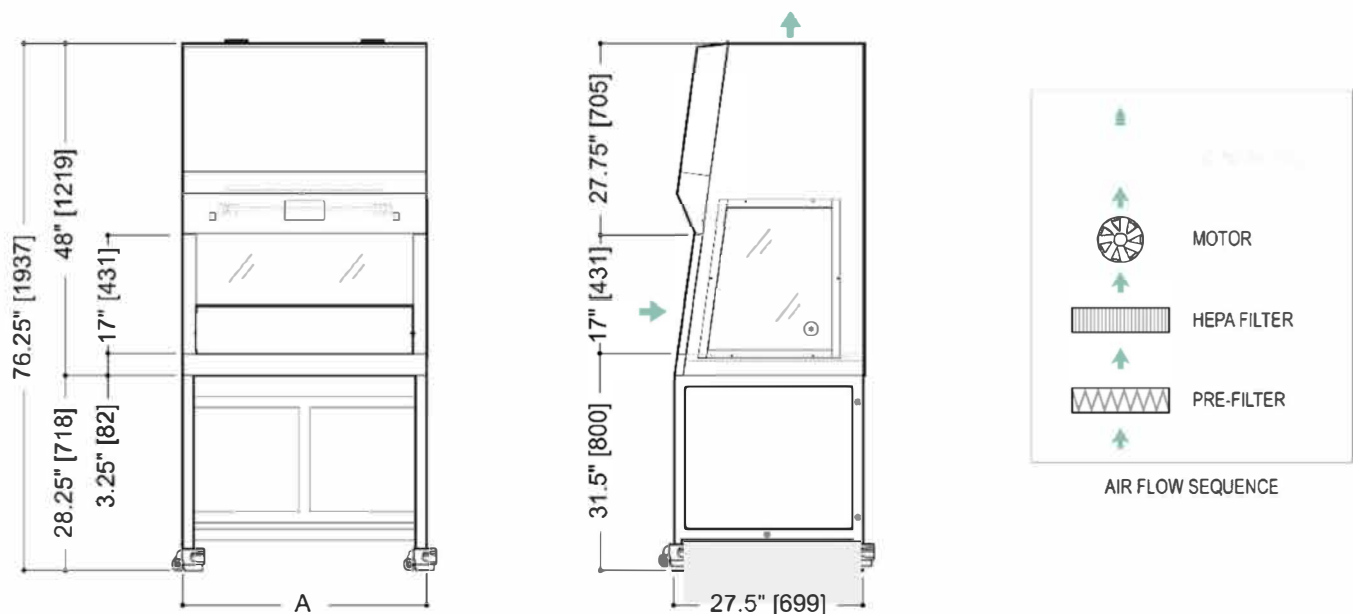

NXT - SERIES 00 – EXTRACTION HOOD – COMPOUNDING MODEL



Model	Dimension A	Work Zone (W x D x H)	Electrical
<input type="checkbox"/> NXT-300	35.375" (900)	31.5" x 21.5" x 22" (800 x 546 x 559)	3A, 115V, 50/60Hz
<input type="checkbox"/> NXT-400	47.25" (1200)	43.5" x 21.5" x 22" (1105 x 546 x 559)	3A, 115V, 50/60Hz

STANDARD FEATURES:

- ✓ Cold-rolled steel construction for exterior shell with durable, anti-bacterial powder coat finish.
- ✓ Stainless steel interior lining, baffle, and dished work surface with electro-polished finish.
- ✓ Microprocessor with LCD display to control lights, fans.
- ✓ LED task lighting & UV germicidal light.
- ✓ Motorized vertical sliding face shield c/w integrated shut-off for fans and UV light when in the closed position.
- ✓ UV resistant safety glass sash and side windows.
- ✓ Exhaust HEPA filter rated 99.99% efficient at 0.3µ.
- ✓ Low flow alarm to monitor HEPA loading at the exhaust.
- ✓ Quick change disposable pre-filter, MERV 8 efficiency.
- ✓ Two cord pass-through grommets in side panels.
- ✓ Manual adjustable base stand for 29"-36" high work surface.
- ✓ 15' power cord with grounded plug.
- ✓ 1year warranty Parts and Labour

OPTIONAL FEATURES:

Accessories

- Stainless steel IV bar, complete with (5) hangers
 - Stainless steel side panels in lieu of safety glass
 - Thimble canopy (bypass) - 8" dia. collar
 - Direct Duct (non-bypass) – 8" dia. collar**
- Total exhaust volume required: 250-270 cfm (NXT-300)
330-350 cfm (NXT-400)

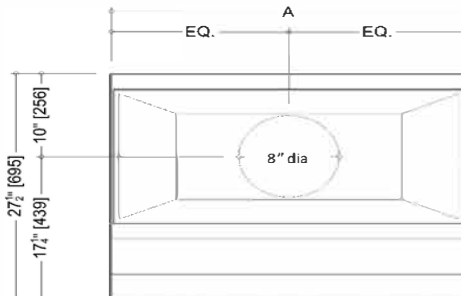

Notes / Comments:

Customer Signature

Date